

ITEM NO.	PART NUMBER	DESCRIPTION	QTY.
1	JS25 basis of mounts		1
2	Adapter Weldment		1
3	MOUNT RING		1
4	Adapter Spacer		1
5	JS50MX -RD1 ASSEMBLY		1
6	92949A540_NO THREADS_18-8 Stainless Steel Button Head Hex Drive Screw		1
7	92949A553_NO THREADS_18-8 Stainless Steel Button Head Hex Drive Screw		1

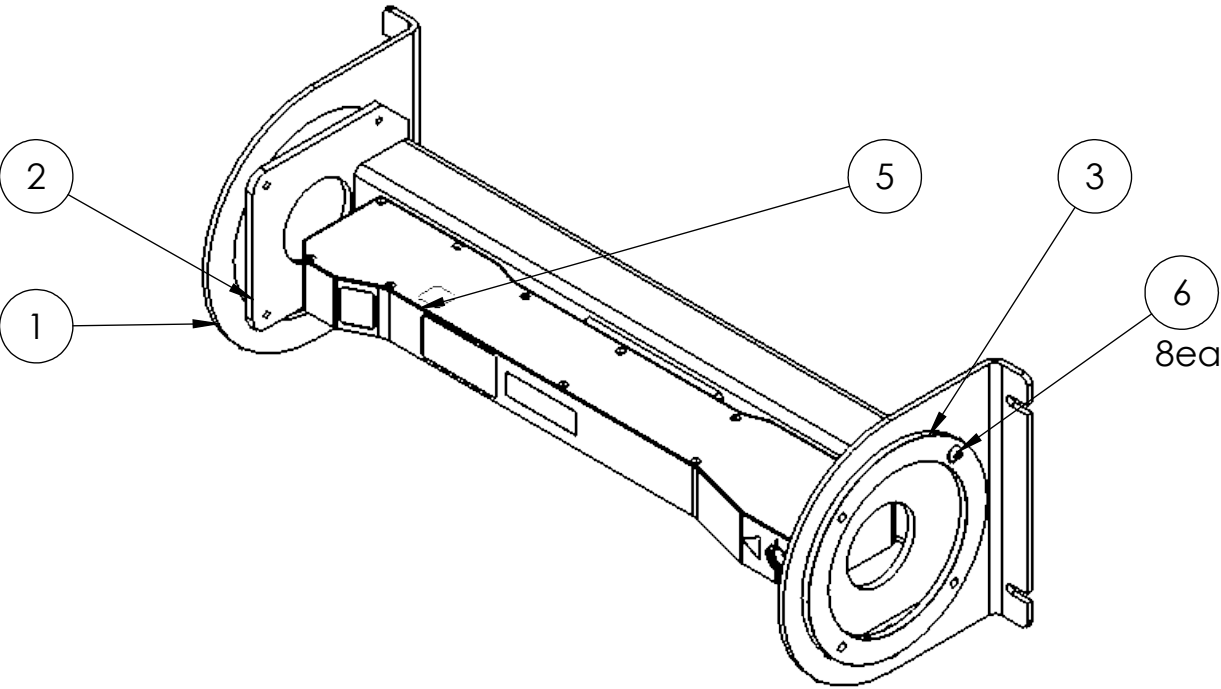

Unless Otherwise Specified	
Machining Tolerances	0.000 ± 0.002 0.00 ± 0.010 0.0 ± 0.1 0. ± .1
Angle	± .5°
Unless Otherwise Specified	
-Dimensions apply after finish -Break all sharp corners to Min 0.001, Max 0.005 -Do not machine stock sizes -All machined surfaces to be 63 (RMS) or better 3rd Angle Projection -Dimensions are in inches	

PROPRIETARY NOTICE: THE INFORMATION CONTAINED IN THIS DRAWING IS THE SOLE PROPERTY OF JOESCAN. IT IS NOT TO BE USED, REPRODUCED, OR DISCLOSED IN WHOLE OR IN PART TO ANYONE WITHOUT THE WRITTEN PERMISSION OF JOESCAN CORPORATION.	
APPROVALS	DATE
DFT:	
CHK:	
ENG: J. KOLLMANN	9/20/2021
APR:	
Material: 6061-T6 Aluminum RoHS Free of debris and oils	
JoeScan	
TITLE JS25 to 50 adapter assembly	
SIZE B	CAGE NO.
SCALE = NONE	WT:
SHEET 1 OF 1	